

AMP "STANDARD QUIET" K.D. TRIPLE TIER LOCKER (18" OR 24" WIDE) (PRODUCT No. SQ _ _ _ _ -3_)

ELEVATION ' ' /

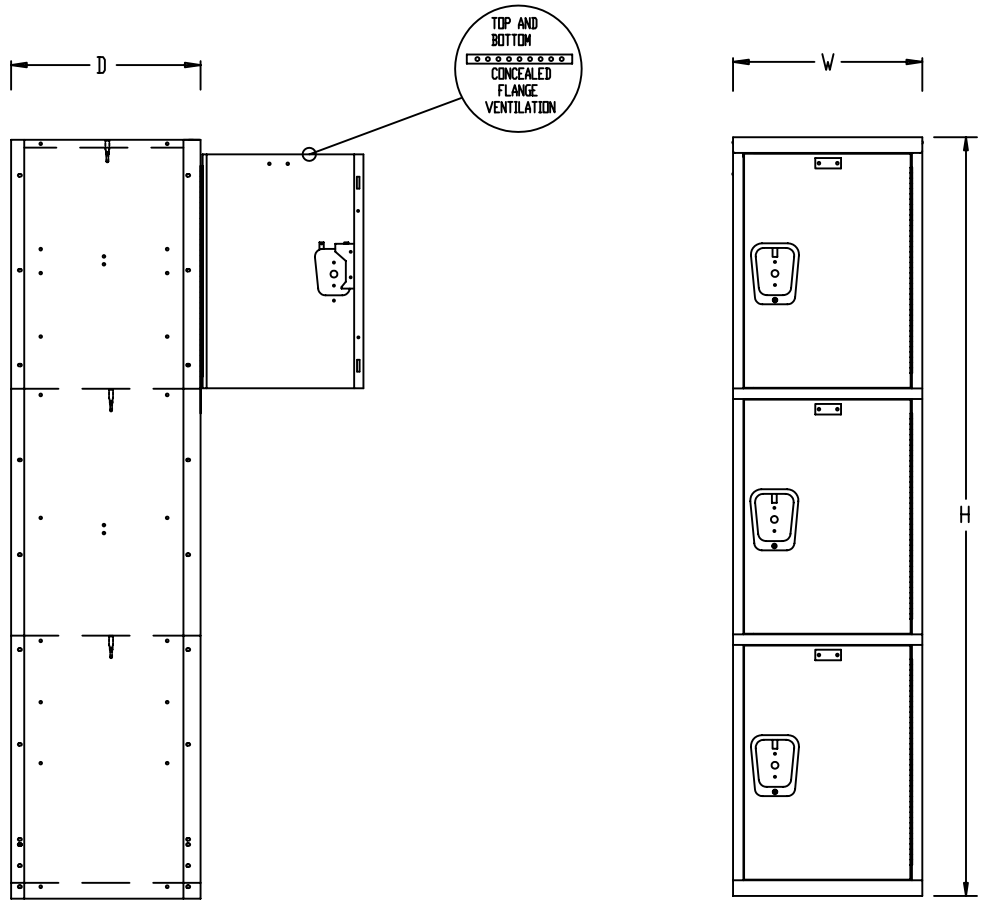

SIDE VIEW

FRONT VIEW

LOCKER DETAILS:

DOOR & FRAME COLOR =
 BODY COMPONENTS COLOR = 729 PARCHMENT
 TOP =
 HANDLE = LIFT (S.S. RECESSED DRAWN)
 DOOR VENTILATION = SOLID
 SIDE VENTILATION = SOLID
 BASE =
 LOCKS =
 HINGE = CONTINUOUS PIANO HINGE

CONTRACTOR NOTE
 ALL CONCRETE BASES SHOULD BE LEVEL AND TROWELED SMOOTH TO ASSURE PROPER INSTALLATION OF THE LOCKERS. ALL FLOORING MATERIAL ATTACHED TO THE FACE OF THE BASE SHOULD BE RECESSED AT LEAST 1/4" FROM THE TOP EDGE OF THE BASE. LOCKERS MUST BE ANCHORED TO WALL.

GAUGES

DOOR = 16 GA., C.R.S.
 FRAME = 16 GA., C.R.S.
 TOP = 24 GA., C.R.S.
 BOTTOM = 24 GA., C.R.S.
 SHELVES = 24 GA., C.R.S.
 SIDES = 24 GA., C.R.S.
 BACKS = 24 GA., C.R.S.

LATCHING: (WARDROBE) TWO POINT RECESSED AUTO-MATIC LOCKING DEVICE WITH LIFT-TYPE PADLOCK HASP. 36" TO 20" TALL DOORS.

ART METAL PRODUCTS

THIS DRAWING AND THE INFORMATION ON IT IS THE CONFIDENTIAL PROPERTY OF ART METAL, INC. AND SHALL NOT BE COPIED OR DISCLOSED TO OTHERS WITHOUT WRITTEN PERMISSION. ONLY ART METAL RESERVES THE RIGHT TO ALTER ANY DESIGN. ANY UNAUTHORIZED MODIFICATIONS RELEASES ART METAL FROM ALL LIABILITIES.
 TOLERANCES UNLESS SPECIFIED:
 FRACTIONS: ±1/32 DECIMALS: ±.010 DEGREES: ±1°

Customer: CUSTOMER	Drawn By: DRAFTER	Checked By:	Date: DATE	Scale: NONE
Customer Order Number: PO#	Acad Number:	PAGE NUMBER		Sheet # Of #
Description: JOB NAME JOB LOCATION	Drawing Number:	FOLDER NUMBER		
		Revision:		