

SAFETY-VIEW K. D. WARDROBE STOCK LOCKER ASSEMBLY INSTRUCTIONS

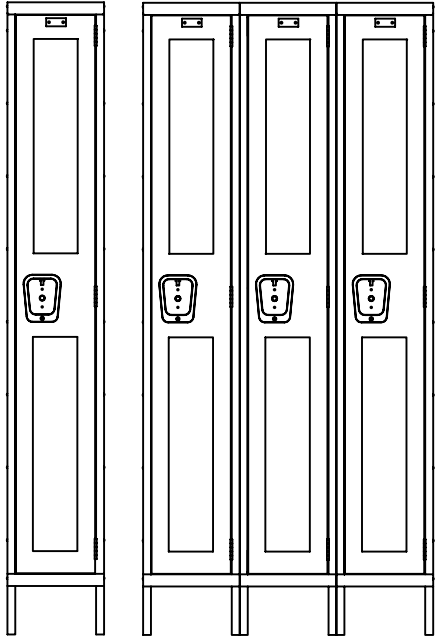

1 WIDE
3 WIDE
SINGLE TIER

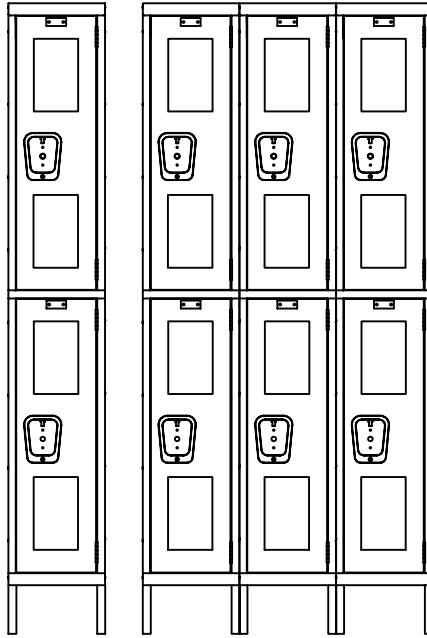

1 WIDE
3 WIDE
DOUBLE TIER

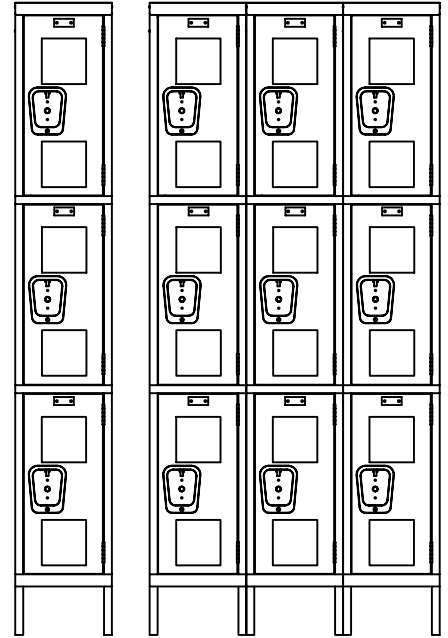

1 WIDE
3 WIDE
TRIPLE TIER

General Instructions

1. Check material received against the packing list. First check the number of packages received and then check the contents of each package.
2. Check material received for damage. If damage has occurred, secure a "damage notation" from the carrier.
3. Identify each part as it is unpacked and put like parts together as close as possible to the working area in which they are to be assembled.
4. Be careful to use the correct hardware as specified in the assembly instructions.
5. Items with suffix (xx) are available options.

CAUTION

IN THE INTEREST OF SAFETY, ALL LOCKERS MUST BE SECURELY ANCHORED TO THE FLOOR AND/OR WALL.
FOR SAFETY, HANDLE ALL COMPONENTS CAREFULLY AND WEAR WORK-GLOVES WHEN ASSEMBLING LOCKERS.

INSTALL ALL UNITS PLUMB AND TIGHTEN ALL HARDWARE SECURELY.

RETAIN INSTRUCTIONS FOR FUTURE REFERENCE.



401 Jim Moran Blvd., P.O. Box 4157 Phone (954) 429-9662
Deerfield Beach, FL 33442 Fax (954) 428-3843

www.ArtMetalProducts.com

SAFETY-VIEW K.D. WARDROBE STOCK LOCKER ASSEMBLY INSTRUCTIONS

PACKAGE CONTENTS

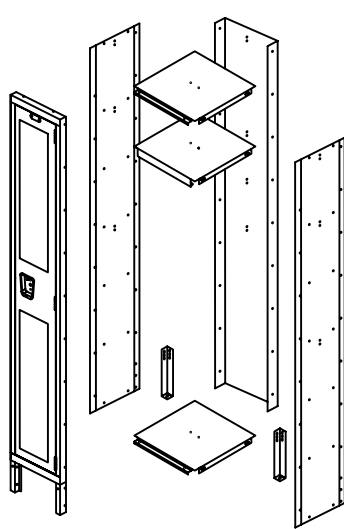
REF. NO.	DESCRIPTION	PART NO.	1-WIDE QUANTITY			3-WIDE QUANTITY			
			1-TIER	2-TIER	3-TIER	1-TIER	2-TIER	3-TIER	
①	REAR PANEL	KR1272	1	1	1	3	3	3	 <p style="text-align: center;">Single Tier KD Locker</p>
②	RIGHT/LEFT SIDE PANEL	KPd72	2	2	2	4	4	4	
③	TOP/BOTTOM SHELF	KS12dd	2	3	4	6	9	12	
④	HAT SHELF	KH12dd	1	-	-	3	-	-	
⑤	SINGLE WALL HOOK	H6K	3	6	-	6	18	-	
⑥	DOUBLE CEILING HOOK	H7K	1	2	3	3	6	9	
xx⑦	COAT ROD HOOK	xxH8K	xx2	-	-	xx6	-	-	
xx⑧	COAT ROD	xxKCR	xx1	-	-	xx3	-	-	
⑨	DOOR FRAME ASSEMBLY	KDF1272-tSV	1	1	1	3	3	3	
x⑩	DOOR	KD1272-tSV	1	2	3	3	6	9	
x⑪	DRAWN HANDLE S.S.	TBECK2	1	2	3	3	6	9	
x⑫	LOCK CHANNEL	KLhh-t	1	2	3	3	6	9	
x⑬	CHANNEL STOP	CS002	2	4	6	6	12	18	
x⑭	NYLON LATCH	DLB100B	2	4	6	6	12	18	
x⑮	SPRING	LS100	2	4	6	6	12	18	
x⑯	LOCK BRACKET	SLB101L	1	2	3	3	6	9	
x⑰	PLASTIC LIFTER	LC100B	1	2	3	3	6	9	
⑱	REAR LEG	KLG	2	2	2	2	2	2	
x⑲	BUMPER	KDB300	3	4	6	9	12	18	
xxx⑳	NUMBER PLATE	NPA-E	1	2	3	3	6	9	
㉑	NUMBER PLATE RIVET	RV101	2	4	6	6	12	18	
㉒	3/8" SLOTLESS BOLT	MBT200	66	80	80	146	184	188	
㉓	HEX NUT	N201	64	76	74	140	172	170	
㉔	ESCUTCHEON PLATE	RPE100	1	2	3	3	6	9	
㉕	HI-DOME CAP NUT	N110	2	4	6	6	12	18	
x㉖	RIVET (HANDLE)	RV102	1	2	3	3	6	9	
x㉗	SAFETY VIEW LEXAN	SVL72-t	2	4	6	6	12	18	
x㉘	LEXAN RETAINER	SVLR	2	4	6	6	12	18	
x㉙	RETAINER RIVET	RV100	4	8	12	12	24	36	
x㉚	RIVET (HINGE)	RV102	6	8	12	18	24	36	

PART NO. LEGEND:

dd = DEPTH
hh = HEIGHT (FRAME)
t = TIER

PART NUMBER SUFFIX SHOWS WIDTH, DEPTH, HEIGHT AND TIER. CUSTOMER TO SPECIFY.

NOTE:

FOR OPTIONAL INDIVIDUAL SLOPE TOPS, SEE SUPPLEMENTAL INSTRUCTION SHEET NO. PKAMP01-A
FOR OPTIONAL 6" HIGH CLOSED METAL BASE, SEE SUPPLEMENTAL INSTRUCTION SHEET NO. PKAMP01-B

x SHIPS PRE-HUNG IN DOOR FRAME ASSEMBLY ⑨ xxx CUSTOMER TO SPECIFY NUMBER SEQUENCE.
xx OPTIONAL ITEM

TWO-YEAR WARRANTY

ART METAL PRODUCTS K.D. LOCKERS ARE COVERED AGAINST ALL DEFECTS IN MATERIALS AND WORKMANSHIP EXCLUDING FINISH, DAMAGE RESULTING FROM DELIBERATE DESTRUCTION AND VANDALISM FOR A PERIOD OF TWO YEARS.



SAFETY-VIEW K.D. WARDROBE STOCK LOCKER ASSEMBLY INSTRUCTIONS

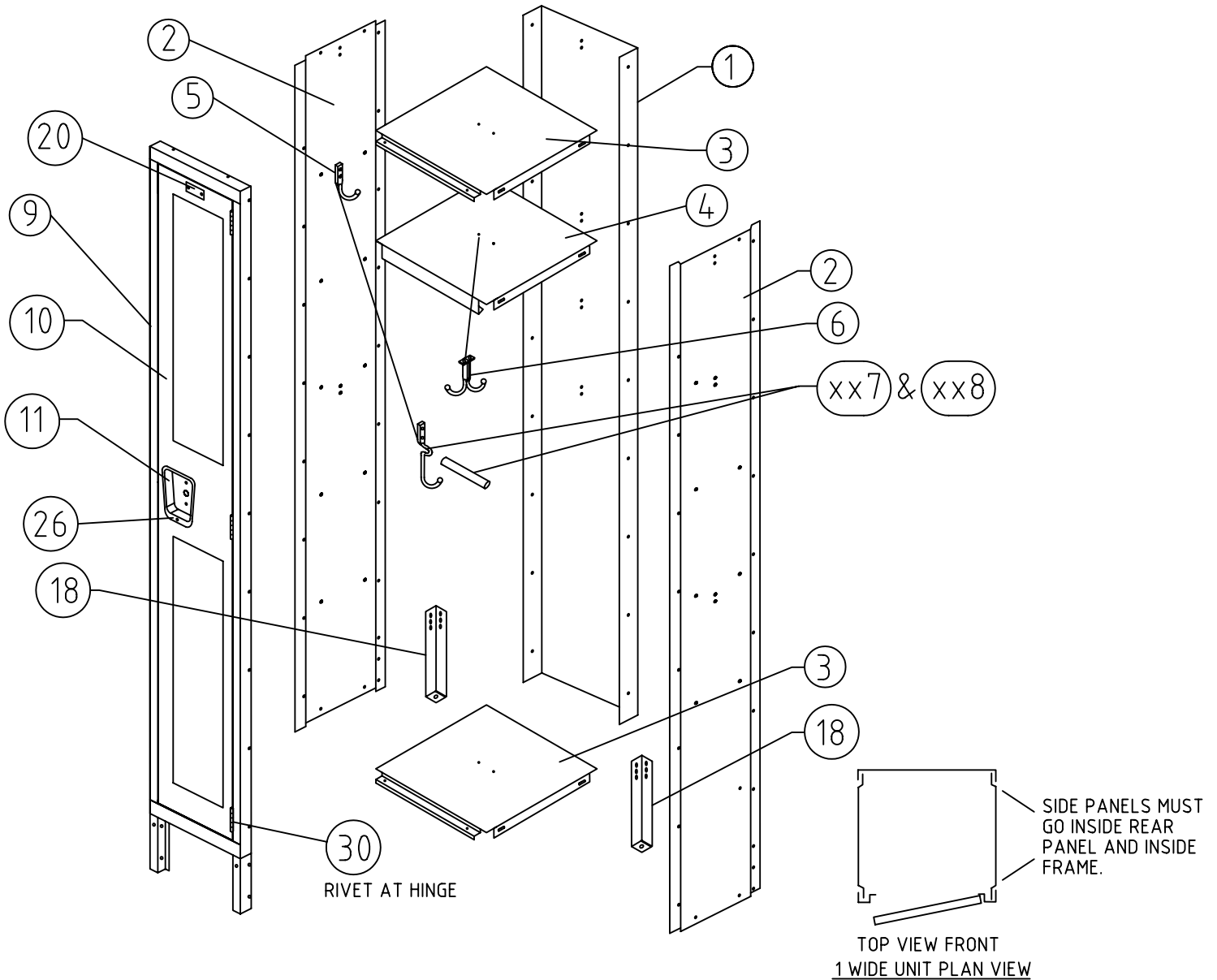

FOLLOW BASIC INSTRUCTIONS
FROM 3-WIDE ASSEMBLY

COAT ROD (KCRww) & COAT ROD HOOKS (H8K) ARE OPTIONAL.

ART METAL PRODUCTS MAKES EVERY EFFORT TO ENSURE THAT ALL UNITS SHIP COMPLETE; HOWEVER, SHOULD YOUR UNIT CONTAIN MISSING OR DAMAGED PARTS, REPLACEMENTS MAY BE OBTAINED FROM ART METAL PRODUCTS. TO OBTAIN PARTS, FOLLOW THESE INSTRUCTIONS.

PLEASE PROVIDE THE FOLLOW INFORMATION:

MODEL NUMBER

DESCRIPTION OF PART(S) NEEDED & PART
NUMBER(S) AS SHOWN IN PARTS LIST

COLOR

PURCHASE DATE

COMPANY NAME & CONTACT PERSON

WHERE THE PRODUCT WAS PURCHASED FROM

IF REQUESTING PARTS BY TELEPHONE, ASK FOR CUSTOMER SERVICE & PROVIDE THE ABOVE INFORMATION.



SAFETY-VIEW K.D. WARDROBE STOCK LOCKER ASSEMBLY INSTRUCTIONS

(A GROUPING OF 3-WIDE SINGLE TIER LOCKERS ILLUSTRATED)

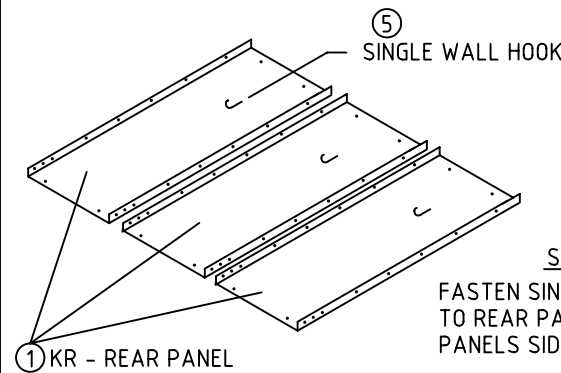

STEP 1
FASTEN SINGLE WALL HOOK(H6K) TO REAR PANELS. LAY REAR PANELS SIDE BY SIDE.

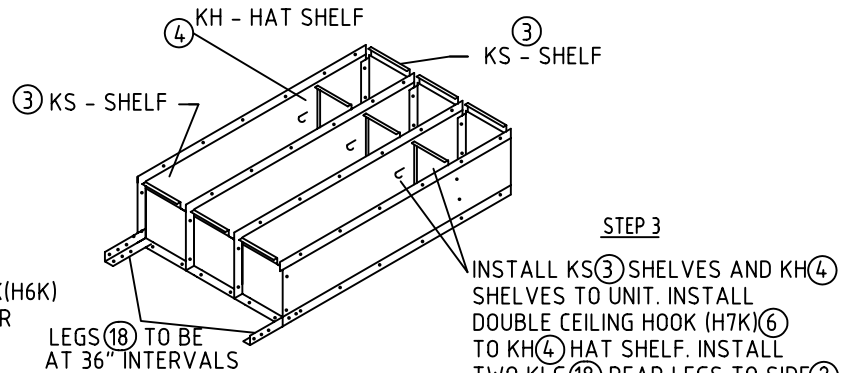

LEGS ⑱ TO BE AT 36" INTERVALS

STEP 3
INSTALL KS ③ SHELVES AND KH ④ SHELVES TO UNIT. INSTALL DOUBLE CEILING HOOK (H7K) ⑥ TO KH ④ HAT SHELF. INSTALL TWO KLG ⑱ REAR LEGS TO SIDE ② AND REAR PANEL ①.

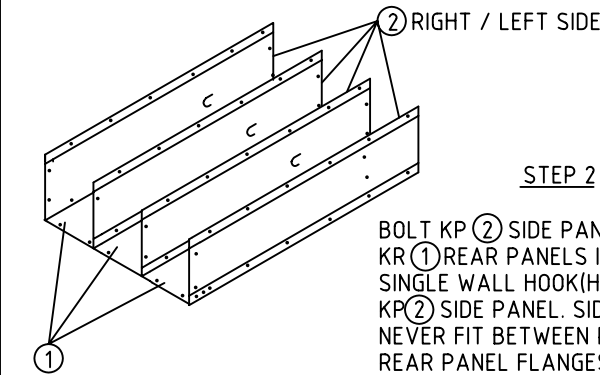

STEP 2
BOLT KP ② SIDE PANELS TO KR ① REAR PANELS. INSTALL SINGLE WALL HOOK(H6K) ⑤ TO KP ② SIDE PANEL. SIDE PANELS ② NEVER FIT BETWEEN KR ① REAR PANEL FLANGES.

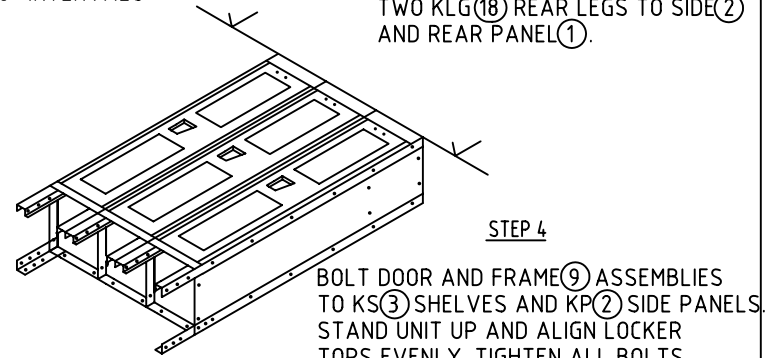

STEP 4
BOLT DOOR AND FRAME ⑨ ASSEMBLIES TO KS ③ SHELVES AND KP ② SIDE PANELS. STAND UNIT UP AND ALIGN LOCKER TOPS EVENLY. TIGHTEN ALL BOLTS AND NUTS.
NOTE: WHEN BOLTING ONE UNIT TO ANOTHER, OMIT ONE SET OF BOLTS IN END FRAME AND SIDE TO MINIMIZE GROWTH FROM BOLT HEADS.

TOOLS REQUIRED: 3/8" NUT DRIVER
(3/8" SOCKET MAY BE SUBSTITUTED)

ASSEMBLY OF SINGLE ROW LOCKERS
NEVER PUT SIDE PANELS BETWEEN FRAMES.

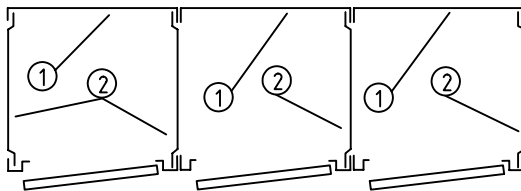

SIDE PANELS MUST GO INSIDE REAR PANEL AND INSIDE FRAME.

SINGLE TIER EXAMPLE - 3 WIDE UNIT PLAN VIEW

OPTIONAL COAT ROD
HOOKS TO BE BOLTED TO SIDE PANELS WITH COAT ROD IN BETWEEN.

xx ⑦ COAT HOOK (xxH8K)
xx ⑧ WITH ROD (xxKCRww)

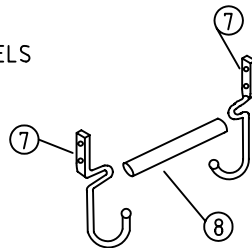

⑥ DOUBLE CEILING HOOK (H7K)

TO BE BOLTED TO UNDERSIDE OF HAT SHELF. USED IN LOCKERS WITH A 15" DEPTH OR LESS.

⑤ SINGLE WALL HOOK (H6K)

TO BE BOLTED TO SIDE PANEL AND TO BACK PANEL.

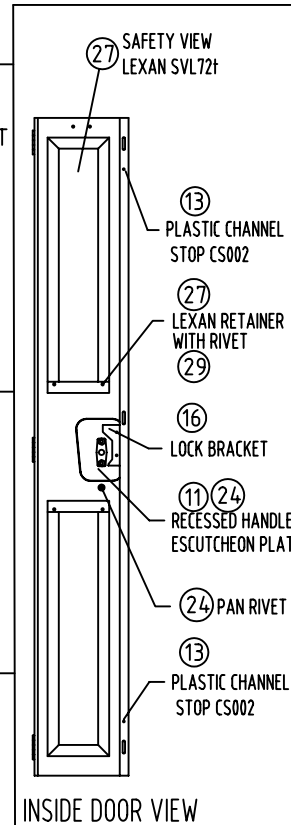

INSIDE DOOR VIEW

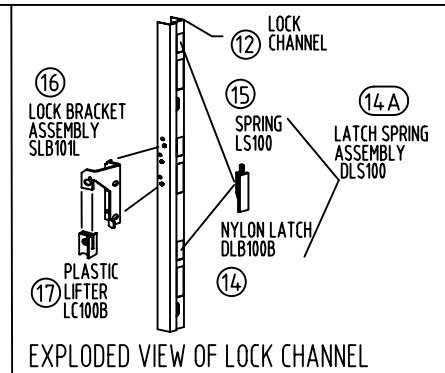

EXPLODED VIEW OF LOCK CHANNEL

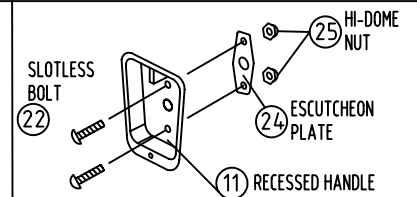

ASSEMBLY OF ESCUTCHEON PLATE

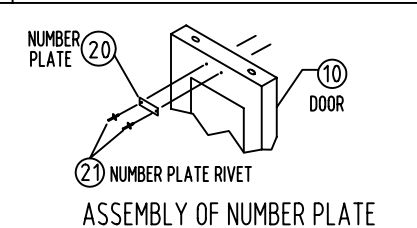

ASSEMBLY OF NUMBER PLATE

